

# FS320-1200

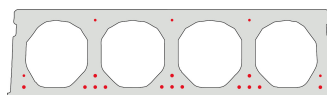

## Technische info

Hoogte	320mm
Breedte	1200mm
Brandweerstand	1 uur (2u op bestelling)
Milieuklasse	XC1; XC2; XC3 (andere op bestelling)
Transportgewicht	3,78 kN/m <sup>2</sup>
Gewicht/ m	4,54 kN/m
Rekengewicht	4,04 kN/m <sup>2</sup>
Kanaalvulling	46,66 l/m
Vulbeton	10,3 l/m <sup>2</sup>
Betonkwaliteit	C 50/60
Staalkwaliteit	f(pk) 1860; f(p0,1k) 1580

## Overspanningen

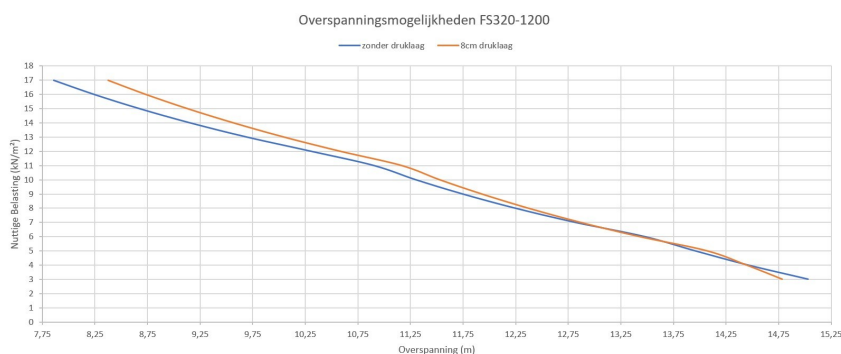

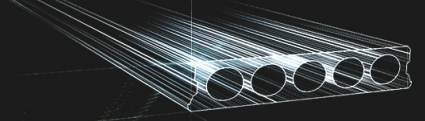

## Pasplaten

---

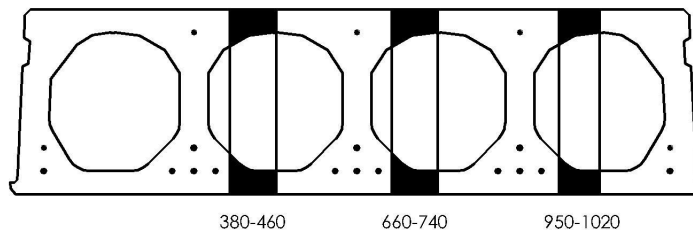

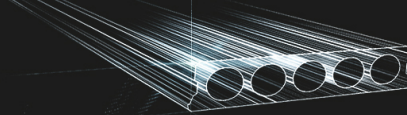

## Booradvies

---

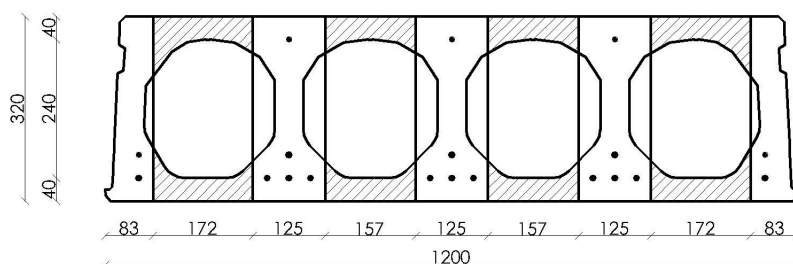

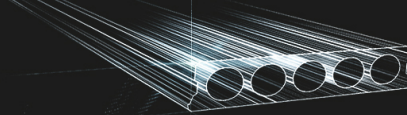

## Wapeningspositie

---

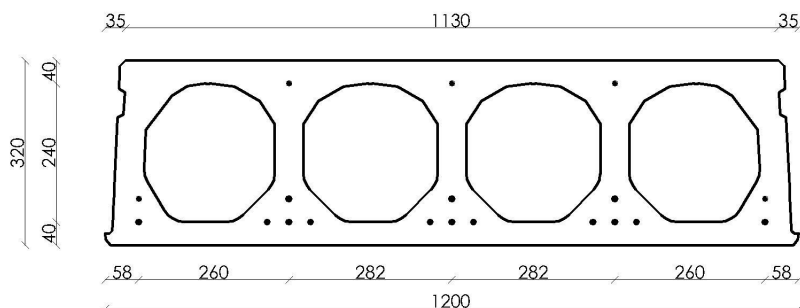

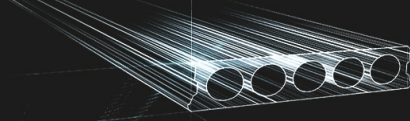

## Supplementen

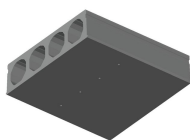

Ontwateringsgaatjes

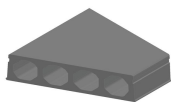

Schuinzagen/inkorten

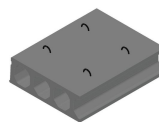

Hijsslussen

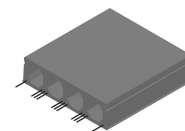

Uitstekende wapening

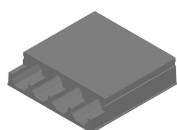

Verdunde bovenzijde

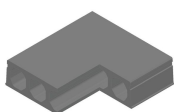

Hoeksparing

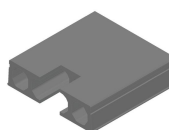

Kopsparing

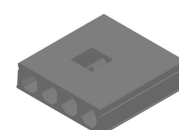

Middensparing

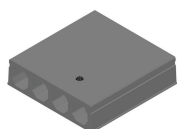

Ronde sparing + CD

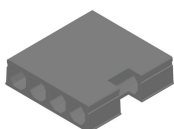

Zijsparing

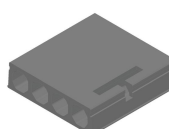

Hamerkop

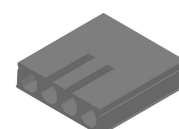

Opengemaakte kanalen



Raveelijzers -  
Voorgespannen



Verdiepte sparing

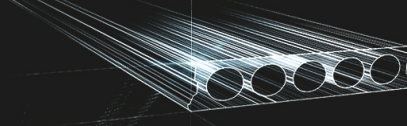

## Voorraad

	Productie	Afhaalbaar	Op voorraad
Malle 1			
Malle 2	X	X	
Frederickx			
Tessenderlo	X	X	

Gedownload op: 29/04/2021 15:38:42



**Fingo**  
Malle 1 Nijverheidsstraat 21  
Malle 2 Industrieweg 22  
Malle B-2390  
+32 (0)3 309 26 26

**Fingo Tessenderlo**  
Truibroek 76  
Ham B-3945

fingo@fingo.be

**Fingo - Frederickx**  
Schuttersveldstraat 11  
Messelbroek B-3270  
+32 (0)13 78 00 78

pagina 6 / 6