

FS400-1200

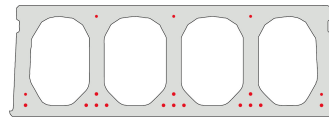

Technische info

Hoogte	400mm
Breedte	1200mm
Brandweerstand	1 uur (2u op bestelling)
Milieuklasse	XC1; XC2; XC3 (andere op bestelling)
Transportgewicht	4,32 kN/m ²
Gewicht/ m	5,18 kN/m
Rekengewicht	4,68 kN/m ²
Kanaalvulling	64,23 l/m
Vulbeton	13,6 l/m ²
Betonkwaliteit	C 50/60
Staalkwaliteit	f(pk) 1860; f(p0,1k) 1580

Overspanningen

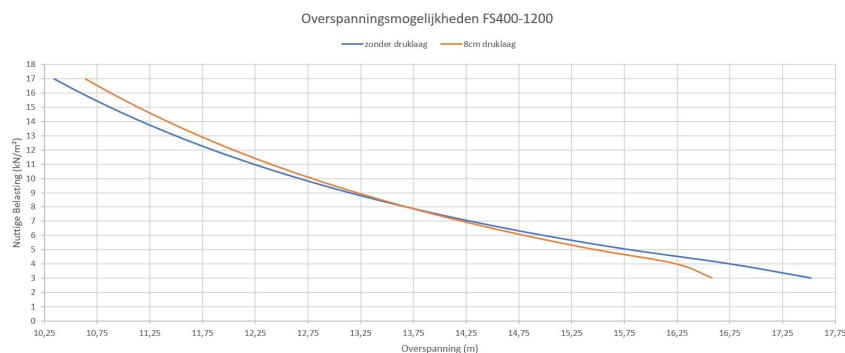

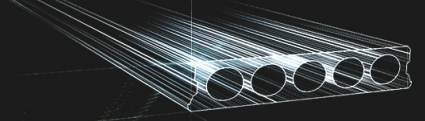

Pasplaten

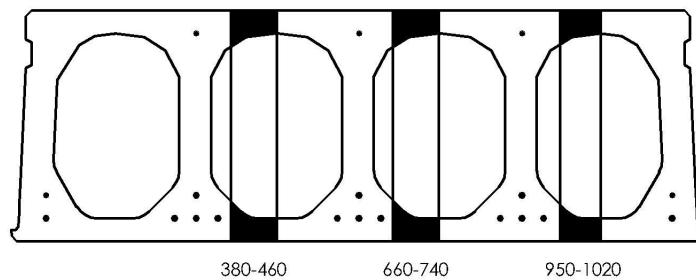

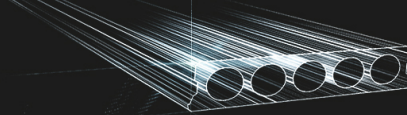

Booradvies

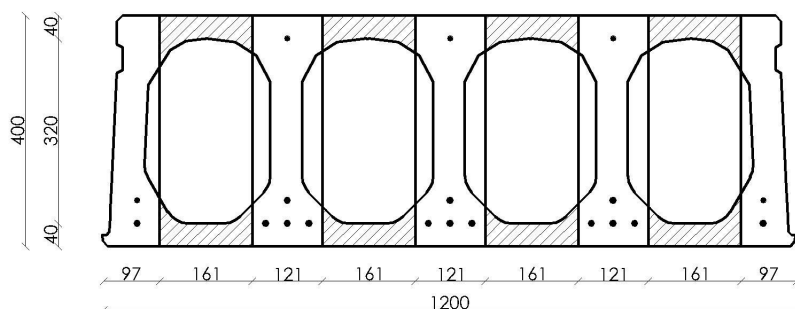

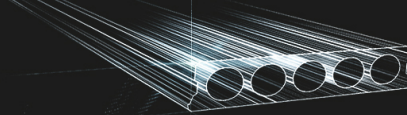

Wapeningspositie

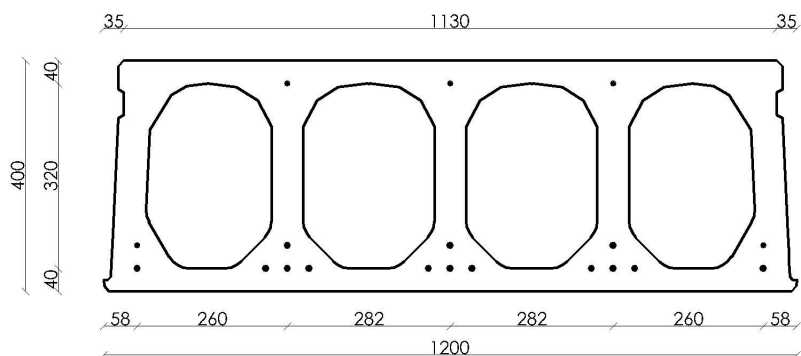

Gedownload op: 06/06/2020 00:40:35

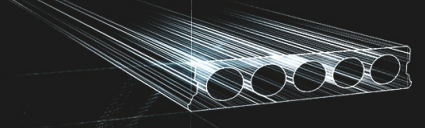

Supplementen

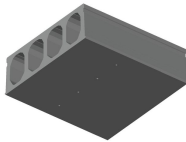

Ontwateringsgaatjes

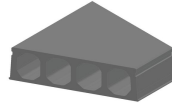

Schuinzagen/inkorten

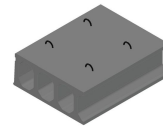

Hijsslussen

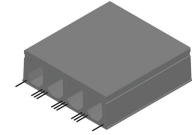

Uitstekende wapening

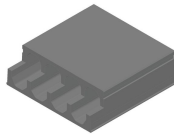

Verdunde bovenzijde



Hoeksparing

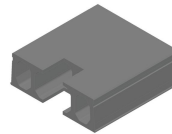

Kopsparing

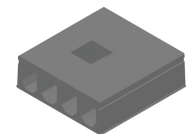

Middensparing

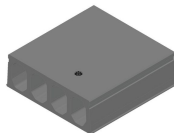

Ronde sparing + CD

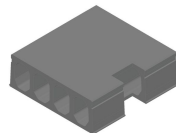

Zijsparing

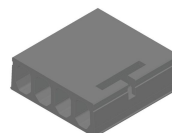

Hamerkop

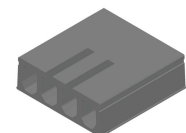

Opengemaakte kanalen

Raveelijzers -
Voorgespannen

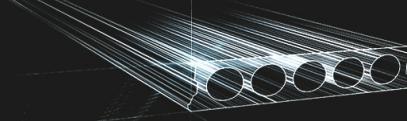

Voorraad

	Productie	Afhaalbaar	Op voorraad
Malle 1			
Malle 2	X	X	
Frederickx			
Tessenderlo	X	X	

Gedownload op: 06/06/2020 00:40:35



Fingo
 Malle 1 Nijverheidsstraat 21
 Malle 2 Industrieweg 22
 Malle B-2390
 +32 (0)3 309 26 26

Fingo Tessenderlo
 Truibroek 76
 Ham B-3945

fingo@fingo.be

Fingo - Frederickx
 Schuttersveldstraat 11
 Messelbroek B-3270
 +32 (0)13 78 00 78

pagina 6 / 6