

# FS265-1200



## Informations techniques

Epaisseur	265mm
Largeur	1200mm
Résistance au feu	1 uur (2u op bestelling)
Classes d'exposition	XC1; XC2; XC3 (andere op bestelling)
Poids au transport	3,35 kN/m <sup>2</sup>
Poids/ m	4,04 kN/m
Poids de calcul	3,55 kN/m <sup>2</sup>
Kanaalvulling	26,15 l/m
Béton de remplissage	8,2 l/m <sup>2</sup>
Qualité du béton	C 50/60
Qualité d'acier	f(pk) 1860; f(p0,1k) 1580

## Travées

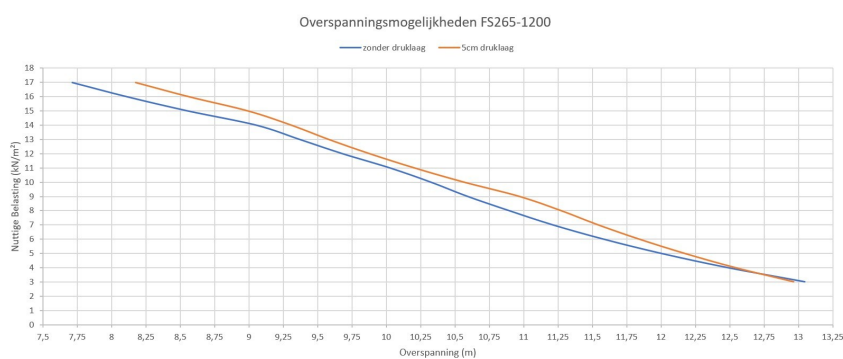

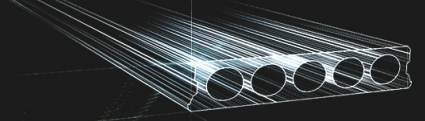

## Plaques d'ajustage

---

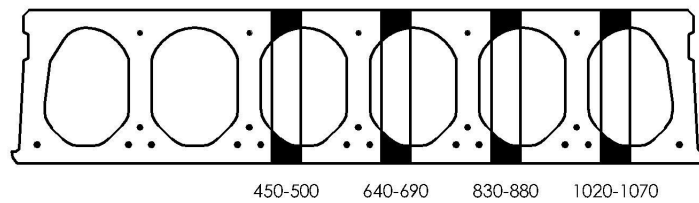

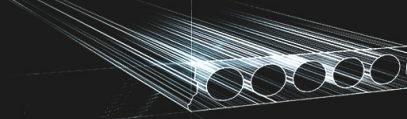

## Conseil de forage

---

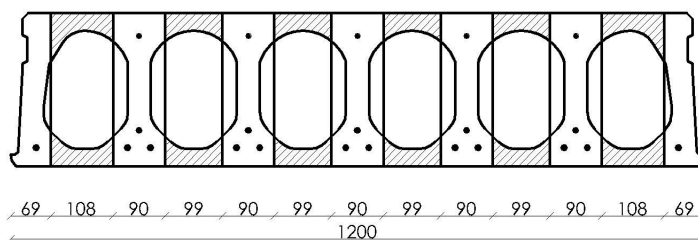

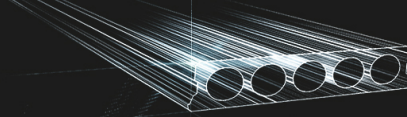

## Position d'armature

---

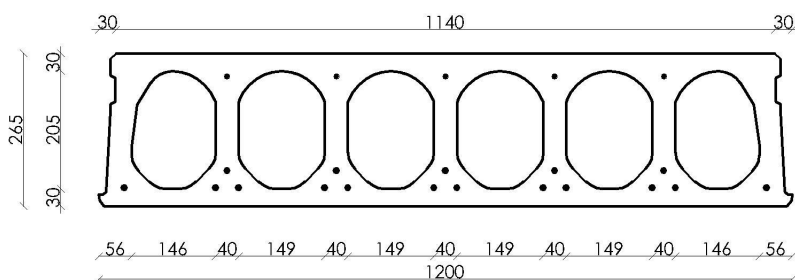

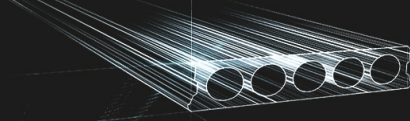

## Suppléments

---

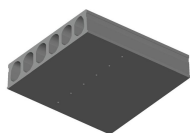

Trous de drainage d'eau

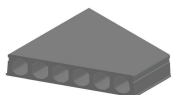

Sciage en coupe oblique

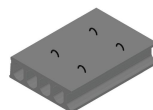

Boucles de levage

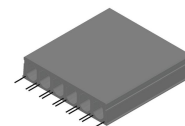

Armatures dépassantes

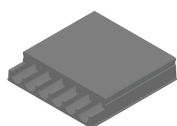

Amincissement supérieur

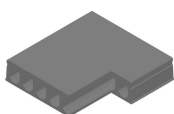

Evidement angulaire

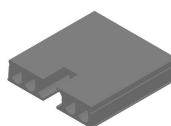

Evidement de tête

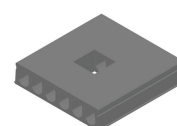

Evidement central

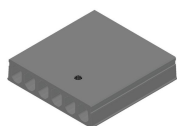

Evidement Ø90 + boîte de dérivation

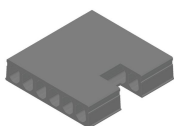

Evidement latéral

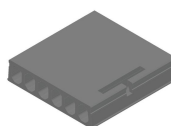

Tête de marteau

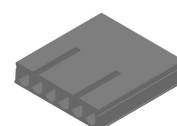

Alvéoles ouvertes



Raveelijzers



Évidement partiel

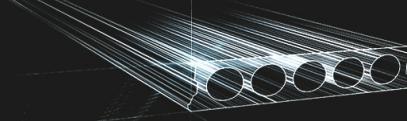

## Stock

	Production	Emporter	Stock
Malle 1			
Malle 2	X	X	
Frederickx			
Tessenderlo	X	X	

gedownload op: 08/03/2021 00:17:22



**Fingo**  
Malle 1 Nijverheidsstraat 21  
Malle 2 Industrieweg 22  
Malle B-2390  
+32 (0)3 309 26 26

**Fingo Tessenderlo**  
Truibroek 76  
Ham B-3945

fingo@fingo.be

**Fingo - Frederickx**  
Schuttersveldstraat 11  
Messelbroek B-3270  
+32 (0)13 78 00 78

page 6 / 6